

Inch

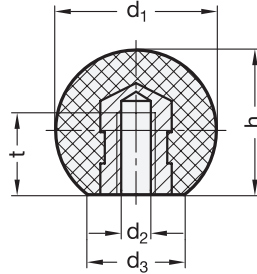

Inch table

Dimensions in: inches / millimeters

<sup>1</sup> $d_1$	<sup>2</sup> $d_2$					$d_3$	$t$	$h$
1.50 38.1	1/4 x 20	5/16 x 18	3/8 x 16	7/16 x 14	1/2 x 13	0.63 16	0.75 19.1	1.44 36.6

Specification

Knob

Plastic, Polypropylene (PP)

- Operating temperature up to 250 °F (121 °C)
- Black, matte finish

Tapped insert

Brass

RoHS

On request

- For certain minimum quantities:
  - Metric sizes
  - Inserts in other materials
  - Threaded metal studs in brass, zinc plated steel or stainless steel
  - Custom colors and other modifications

Plastic ball knobs WD 595 are a more shatter and shock resistant option than their phenolic counterpart. Resistant to solvents, oils, grease and other chemical agents.

see also...

**DIN 319** Ball Knobs (Metric) Page QVX

Technical Information

Plastic Characteristics QVX

How to order

**WD595-1.50-5/16X18**

<sup>1</sup> Ball diameter  $d_1$

<sup>2</sup> Thread  $d_2$

1.1  
1.2  
1.3  
1.4  
2.1  
2.2  
2.3  
2.4

