

Metric

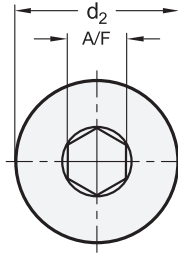
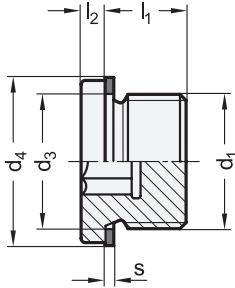

**SS** Stainless Steel

**3 Type**

- A** Without sealing washer
- AC** With copper sealing washer
- AA** With aluminum sealing washer
- AN** With stainless steel sealing washer

**Specification**

**Threaded plug**

- Steel **ST**
- Zinc plated, blue passivated finish
- Property class 5.8
- Stainless steel AISI 316 / AISI 316Ti **A4**

**Sealing washer DIN 7603** (Type AC / AA / AN)

RoHS

Threaded plugs DIN 908 are used, for example, on filling, drain or inspection openings of gear boxes and hydraulic tanks.

**see also...**

	<b>Page</b>
<b>EN 746</b> Threaded Plugs (Plastic)	QVX
<b>GN 749</b> Threaded Plugs (with Seal)	QVX
<b>DIN 910</b> Threaded Plugs (with External Hex)	QVX

**Technical Information**

ISO Fundamental Tolerances	QVX
Strength Values of Screws	QVX
Stainless Steel Characteristics	QVX

**Accessory**

<b>DIN 7603</b> Sealing Washers	QVX
---------------------------------	-----

**How to order**

<b>1</b>	<b>Material</b>
<b>2</b>	<b>Fine thread d<sub>1</sub> (Pipe thread d<sub>1</sub>)</b>
<b>3</b>	<b>Type</b>

**DIN 908-ST-M24X1.5-AN**

3.1  
3.2  
3.3  
3.4  
3.5  
3.6  
3.7  
3.8  
3.9  
3.10

## Metric table



Dimensions in: millimeters / inches

<b>d<sub>1</sub></b>			<b>d<sub>2</sub> h14</b>	<b>d<sub>3</sub></b>	<b>d<sub>4</sub></b> Outer Ø sealing washer	<b>l<sub>1</sub> ±0.2</b>	<b>l<sub>2</sub> +0.5</b>	<b>s</b>	<b>A/F</b>
Fine thread	Pipe thread								
Steel ST	Stainless steel A4	Steel ST Stainless steel A4							
M 8 x 1	M 8 x 1	-	12 0.472	8.3 0.33	11.5 0.45	8 0.315	3 0.12	1 0.04	4
M 10 x 1	M 10 x 1	-	14 0.551	10.3 0.41	13.5 0.53	8 0.315	3 0.12	1 0.04	5
-	-	G 1/8	14 0.551	10 0.39	13.5 0.53	8 0.315	3 0.12	1 0.04	5
M 12 x 1.5	M 12 x 1.5	-	17 0.669	12.3 0.48	16 0.63	12 0.472	3 0.12	1.5 0.06	6
-	-	G 1/4	18 0.709	13.4 0.53	18 0.71	12 0.472	3 0.12	1.5 0.06	6
M 14 x 1.5	M 14 x 1.5	-	19 0.748	14.3 0.56	18 0.71	12 0.472	3 0.12	1.5 0.06	6
M 16 x 1.5	M 16 x 1.5	-	21 0.827	16.3 0.64	20 0.79	12 0.472	3 0.12	1.5 0.06	8
-	-	G 3/8	22 0.866	17 0.67	21 0.83	12 0.472	3 0.12	1.5 0.06	8
M 18 x 1.5	M 18 x 1.5	-	23 0.906	18.3 0.72	22 0.87	12 0.472	4 0.16	1.5 0.06	8
M 20 x 1.5	M 20 x 1.5	-	25 0.984	20.3 0.80	24 0.94	14 0.551	4 0.16	1.5 0.06	10
-	-	G 1/2	26 1.024	21.3 0.84	26 1.02	14 0.551	4 0.16	1.5 0.06	10
M 22 x 1.5	M 22 x 1.5	-	27 1.063	22.3 0.88	27 1.06	14 0.551	4 0.16	1.5 0.06	10
M 24 x 1.5	M 24 x 1.5	-	29 1.142	24.3 0.96	29 1.14	14 0.551	4 0.16	2 0.08	12
M 26 x 1.5	-	-	31 1.220	26.3 1.04	31 1.22	16 0.630	4 0.16	2 0.08	12
M 27 x 2	-	-	32 1.260	27.3 1.07	32 1.26	16 0.630	4 0.16	2 0.08	12
-	-	G 3/4	32 1.260	26.7 1.05	32 1.26	16 0.630	4 0.16	2 0.08	12
M 30 x 1.5	-	-	36 1.417	30.3 1.19	36 1.42	16 0.630	4 0.16	2 0.08	17
M 33 x 2	-	-	39 1.535	33.3 1.31	39 1.54	16 0.630	5 0.20	2 0.08	17
-	-	G 1	39 1.535	33.5 1.32	39 1.54	16 0.630	5 0.20	2 0.08	17
M 42 x 2	-	-	49 1.929	42.3 1.67	49 1.93	16 0.630	5 0.20	2 0.08	22
-	-	G 1 1/4	49 1.929	42.2 1.66	49 1.93	16 0.630	5 0.20	2 0.08	22
M 48 x 2	-	-	55 2.165	48.3 1.90	55 2.17	16 0.630	5 0.20	2 0.08	24
-	-	G 1 1/2	55 2.165	48.1 1.89	55 2.17	16 0.630	5 0.20	2 0.08	24