

5 Type

A Without screws

Metric table

Dimensions in: millimeters - *inches*

1	2	3	4							
s ₁	s ₂	n	d ₁		d ₂ For screw	h ₁	h ₂	m ₁	m ₂	Grid size
30 <i>1.18</i>	60 <i>2.36</i>	6 <i>0.24</i>	M 8	M 10	M 6	12 <i>0.47</i>	5 <i>0.20</i>	30 <i>1.18</i>	-	30 <i>1.18</i>
40 <i>1.57</i>	80 <i>3.15</i>	8 <i>0.31</i>	M 10	M 12	M 8	16 <i>0.63</i>	6.5 <i>0.26</i>	40 <i>1.57</i>	-	40 <i>1.57</i>
60 <i>2.36</i>	60 <i>2.36</i>	6 <i>0.24</i>	M 10	M 12	M 6	12 <i>0.47</i>	5 <i>0.20</i>	30 <i>1.18</i>	30 <i>1.18</i>	30 <i>1.18</i>
80 <i>3.15</i>	80 <i>3.15</i>	8 <i>0.31</i>	M 12	M 16	M 8	16 <i>0.63</i>	6.5 <i>0.26</i>	40 <i>1.57</i>	40 <i>1.57</i>	40 <i>1.57</i>

Specification

- Zinc die-cast, black
- RoHS



ZS

Accessory

- T-nuts GN 50i → page QVX

Information

Support / base plates GN 80i affix attachments such as leveling feet or castors to aluminum profiles.

They are installed in the profile holes on the end faces using suitably tapped threaded holes or thread-forming screws. Support / base plates can also be fastened lengthwise in the profile slot.

see also...

- Aluminum Profiles GN 10i (Profile Type Light) → page QVX
- Aluminum Profiles GN 10i (Profile Type Heavy) → page QVX
- Aluminum Profiles GN 11i (with Partially Closed Slots) → page QVX

How to order	
1	Width s ₁
2	Length s ₂
3	Slot width n
4	Thread d ₁
5	Type
6	Material / Color

GN 80i-40 80 8 M10-A-ZS

Assembly Instructions / Profile Machining

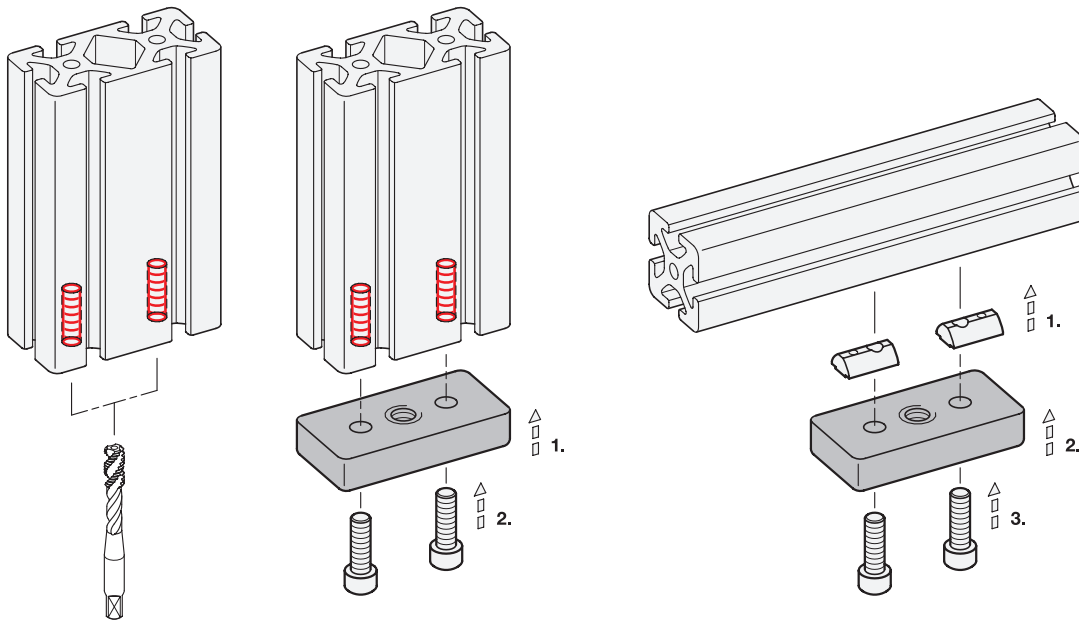

3.1

3.2

3.3

3.4

3.5

3.6

3.7

3.8

3.9

3.10

