

Component parts of assembly set:

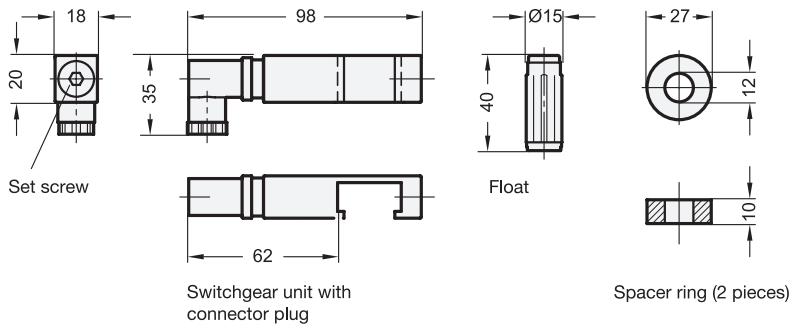

Type *
NO 1 switchgear with one normally open contact
NC 1 switchgear with one normally closed contact
NO-NC 2 switchgears, each of them with one normally open contact and one normally closed contact
NC-NC 2 switchgears, each of them with one normally closed contact
NO-NO 2 switchgears, each of them with one normally open contact

* One float is assigned to each type

Specification

- Switchgear unit
Plastic
Technopolymer (Polyamide PA)
- Temperature resistant up to 176 °F (80 °C)
- Black
- Float
Plastic
Technopolymer (Polypropylene PP)
Black
- IP Protection Classes → page QVX
- Plastic Characteristics → page QVX
- RoHS compliant

Information

With EN 654.2 assembly sets the fluid level of EN 654 and EN 654.1 fluid level indicators can not only be viewed, but also be monitored via an electric contact.

For this purpose, a float with a magnet is located within the indication range, which will close or open a contact at a certain fluid level (REED switch).

Depending on the type, one or two switchgear units may be positioned along the visual range.

When delivered, the switchgear units are assembled such that the housing and the plug connection are on the left side of the fluid level indicator.

Depending on the installation situation, the switchgear unit can also be mounted to the right and the contact insert of the plug can be mounted in 4 positions every 90° to ensure a favorable cable outlet.

see also...

- List of Fluid Level Indicator Types → page QVX

How to order	1	Type
EN 654.2-NO		

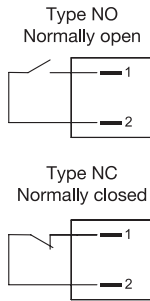

Electrical characteristics

Max. switching voltage / max. switching current	230 V AC, 230 V DC / 2 A
Max. switching capacity	40 W
Connector plug	DIN EN 175301-803 Type C
Protection class	IP 65
Cable gland	PG 7, for cable Ø from 6 to 7 mm
Cable cross-section	2 x 1.5 mm ²

Caution: Magnetic fields impair the function!

Assembly sequence for cable connection

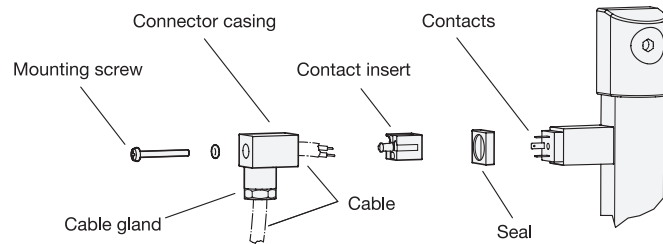

1. Loosen the mounting screw and pull off the connector plug.
2. Push the contact insert out of the connector casing.
3. Loosen the cable gland, guide the cable through the connector casing and connect it to the contact insert.
4. Push the contact insert back into the connector casing and tighten the cable gland for strain relief / sealing of the cable.
5. Push the connector plug over the contacts of the float switch and secure it with the mounting screw.

Assembly sequence for the assembly set on EN 654 / EN 654.1 fluid level indicators

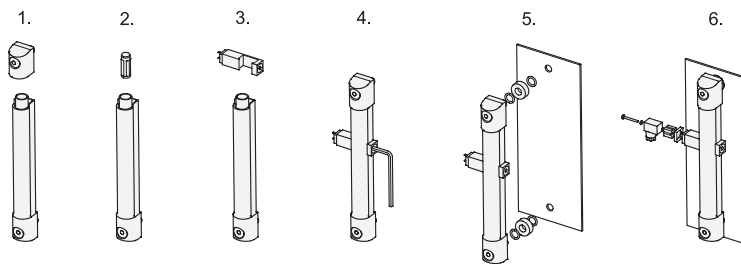

1. Take off the end piece of the fluid level indicator.
2. Insert and correctly position the float with the marking „UP“ pointing up.
3. Push on the switchgear unit.
4. Clamp the switchgear unit in the desired position and reassemble the end piece.
5. Mount the fluid level indicator in the container wall using both plastic spacer rings if the container is made of ferromagnetic material.
6. Mount the cable connection.

3-1
3-2
3-3
3-4
3-5
3-6
3-7
3-8
3-9
3-10

