

3.1
3.2
3.3
3.4
3.5
3.6
3.7
3.8
3.9
3.10

Type C

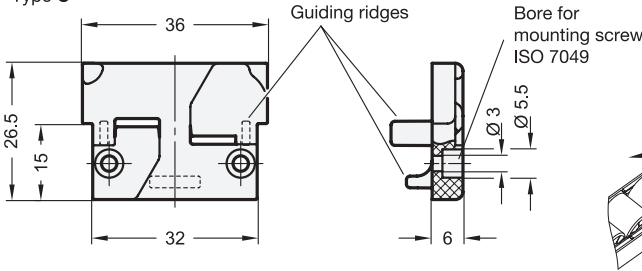

Type E

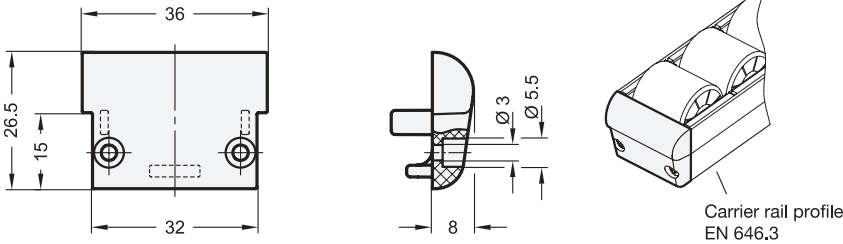

Metric



elesa
ELESA original design RLT-HJ/HE



Type

C Connector

E End cap

Specification

End cap

- Plastic, Polyamide (PA)
- Black
- Operating temperature
-4 °F to +194 °F (-20 °C to +90 °C)

Pan-head tapping screws

Stainless steel

RoHS

Connectors (type C) EN 646.6 can be used to create longer carrier rail profile extensions. Assembled with two screws at each profile end, the carrier rail profiles are interconnected without any further mounting hardware as shown in the drawing. The connecting point cannot carry any weight and must be supported from underneath.

End caps (type E) are the preferred end finishing components for roller track or ball rail assemblies. They also cover the sharp edges of the carrier rail profiles.

Two pan-head tapping screws ISO 7049-ST2, 9x13 for mounting the connectors and end caps are included.

see also...	Page
EN 646.3 Carrier Rail Profiles (Aluminum)	QVX

Technical Information

Plastic Characteristics	QVX
-------------------------	-----

How to order

EN 646.6-C

1 Type