

Identification no. 1 (Size  $d_1 = 18$ )

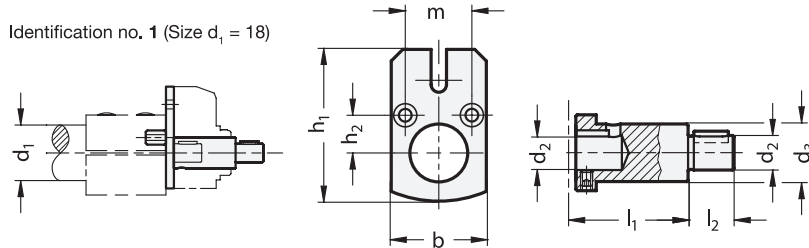

Identification no. 1 (Size  $d_1 = 30..60$ )

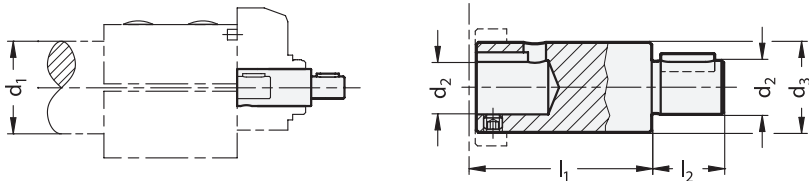

Identification no. 2

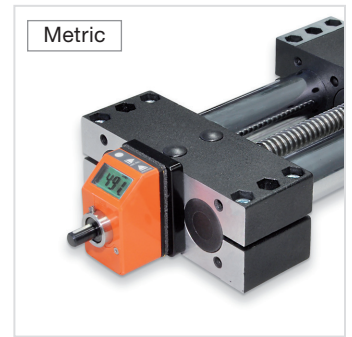
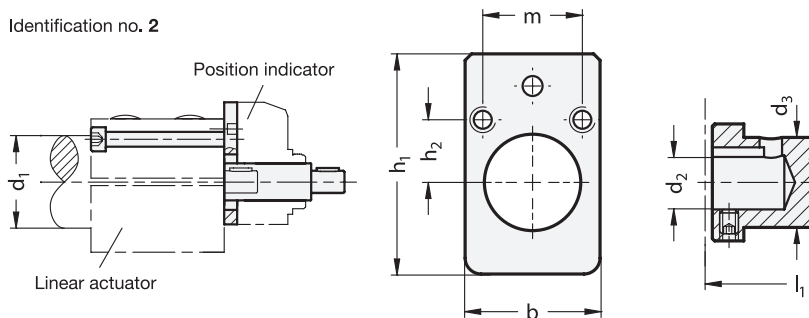

**3 Identification no.**

- 1 For mechanical position indicators EN 953 / EN 954 / EN 955
- 2 For electronic position indicators EN 9053 / EN 9054

**Metric table**

Dimensions in: millimeters - inches

<b>d<sub>1</sub></b> Ø Linear actuator	<b>d<sub>2</sub> f7</b>	<b>b</b>	<b>d<sub>3</sub></b>	<b>l<sub>1</sub></b>		<b>l<sub>2</sub></b>	<b>h<sub>1</sub></b>	<b>h<sub>2</sub></b>	<b>m</b>	For position indicator
				Identification no. 1	Identification no. 2					
18 0.71	6 0.24	27 1.06	10 0.39	30 1.18	-	16 0.63	38.5 1.52	10 0.39	20 0.79	EN 955
30 1.18	8 0.31	40 1.57	14 0.55	35 1.38	44 1.73	15 0.59	54.5 2.15	15 0.59	30 1.18	EN 954 / EN 9054
40 1.57	12 0.47	50 1.97	20 0.79	39 1.54	51 2.01	16 0.63	72.5 2.85	19.5 0.77	39 1.54	EN 953 / EN 9053
50 1.97	12 0.47	60 2.36	20 0.79	39 1.54	51 2.01	17 0.67	72.5 2.85	23 0.91	46 1.81	EN 953 / EN 9053
60 2.36	14 0.55	70 2.76	20 0.79	39 1.54	51 2.01	18 0.71	72.5 2.85	27.5 1.08	55 2.17	EN 953 / EN 9053

**Specification**

- Adaptor shaft  
Steel, blackened finish
- Torque support  
Aluminum, black anodized finish
- ISO Fundamental Tolerances → page 2129
- RoHS

**Accessory**

- Position indicators and handwheels have to be ordered separately.

**Information**

GN 491.1 installation kits are required for mounting a position indicator on double tube linear actuators. The kit consists of an adaptor shaft and, depending on the position indicator, a torque support including mounting screws.

When ordering EN 953 / EN 954 / EN 955 mechanical position indicators, a counter needs to be chosen that matches the pitch of the trapezoidal thread spindle.

For EN 9053 / EN 9054 position indicators, the corresponding pitch is set on the position indicator by programming.

see also...

- Digital Position Indicators EN 953 / EN 954 / EN 955 → starting from page 372
- Digital Position Indicators EN 9053 / EN 9054 → page 378 / 380

<b>How to order</b> <b>GN 491.1-50-12-1</b>	<b>1</b>	Linear actuator diameter $d_1$
	<b>2</b>	Linear actuator thread diameter $d_2$
	<b>3</b>	Identification no.

3.1  
3.2  
3.3  
3.4  
3.5  
3.6  
3.7  
3.8  
3.9  
3.10