

Metric

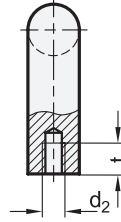
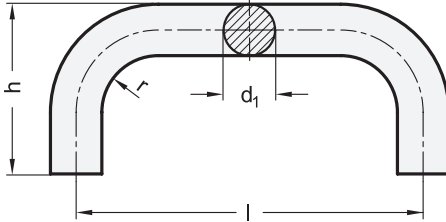

## Metric table

d <sub>1</sub>	Length l		d <sub>2</sub>	h	r	t min.
	SW / SR / BL	SMA / WSA				
20 0.79	200 7.87	200 7.87	M 8	68 2.68	22 0.87	15 0.59
20 0.79	250 9.84	250 9.84	M 8	68 2.68	22 0.87	15 0.59
20 0.79	300 11.81	300 11.81	M 8	68 2.68	22 0.87	15 0.59
20 0.79	350 13.78	-	M 8	68 2.68	22 0.87	15 0.59
28 1.10	250 9.84	250 9.84	M 10	78 3.07	32 1.26	15 0.59
28 1.10	300 11.81	300 11.81	M 10	78 3.07	32 1.26	15 0.59
28 1.10	350 13.78	-	M 10	78 3.07	32 1.26	15 0.59
28 1.10	400 15.75	400 15.75	M 10	78 3.07	32 1.26	15 0.59

Dimensions in: millimeters / inches

## Specification

## Aluminum

- Powder coated, textured finish
  - Black, RAL 9005, UV-resistant
  - Silver, RAL 9006

- SW
- SR

- Powder coated, antimicrobial
  - White, RAL 9016
  - Black, RAL 9005

- WSA
- SMA
- BL

- Plain finish, tumbled

RoHS

## On request

- Special designs
- Various metric size fasteners and kit packaging

Cabinet U-handles GN 426 are manufactured from a bent aluminum profile and have excellent stability and ergonomic design.

In addition to the standard finishes, these cabinet U-handles are also available with a functional coating.

## see also...

	Page
GN 428 Cabinet U-Handles (Aluminum)	QVX
GN 426.2 Cabinet U-Handles (Mounting from the Operator's Side)	QVX

## Technical Information

Product Family Sanline	QVX
Load Capacity Information	QVX

## Accessory

	Page
GN 181 Mounting Plate Sets (Mounting from the Operator's Side)	QVX

## How to order

1	Material
2	Handle diameter d <sub>1</sub>
3	Length l
4	Finish

GN 426-AL-28-300-SW