

Metric

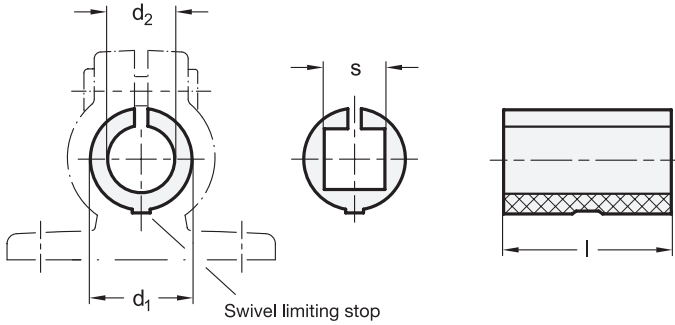

elesa

Original design TCC-A / TCC-A-Q

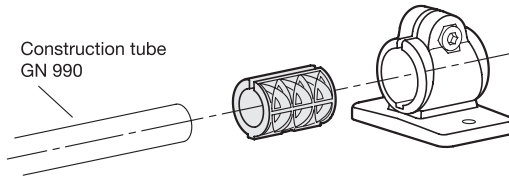

Metric table

Dimensions in: millimeters / inches

¹ d ₁ Bore Clamp connector	² d ₂ Bore				² s Square		³ Length l
18 0.71	B 12	B 14	B 15	B 16	V 10	V 12	29 1.14
30 1.18	B 20	B 25	-	-	V 20	-	45 1.77

Specification

Plastic, Polyamide (PA)

- Glass fiber reinforced
- Operating temperature
-4 °F to 212 °F (-20 °C to +100 °C)
- Color
 - Black, RAL 9005, matte finish
 - Gray, RAL 7040, matte finish
 - Blue, RAL 5005, matte finish
- FDA compliant material
- Visually detectable

- SW
- GR
- VDB

Adapter bushings EN 290 can be used to reduce the bore diameter of plastic clamp connectors. Due to the affixed swivel limiting stop, the adapter bushing cannot rotate or slide inside the clamp connector. The plastic used in version VDB is made from blue, visually detectable and FDA compliant plastic granulate as per FDA CFR.21 and EU 10/2011.

see also...	Page
GN 990 Construction Tubes (Aluminum / Stainless Steel)	QVX
GN 480.1 Square Tubes (Aluminum / Stainless Steel)	QVX

Technical Information

Plastic Characteristics	QVX
-------------------------	-----

RoHS

How to order

¹	Bore d ₁
²	Bore d ₂ (Square s)
³	Length l
⁴	Color

EN 290-30-B20-45-SW

3.1
3.2
3.3
3.4
3.5
3.6
3.7
3.8
3.9
3.10