

**Assembly / profile machining**

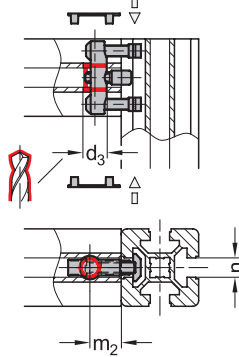

**Metric**

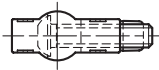
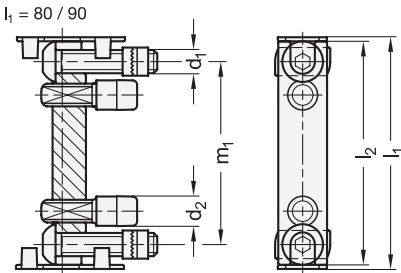

- 3 Type**
- N** Nut without increased torque
- 4 Coding**
- C** With fastening set

**Use**

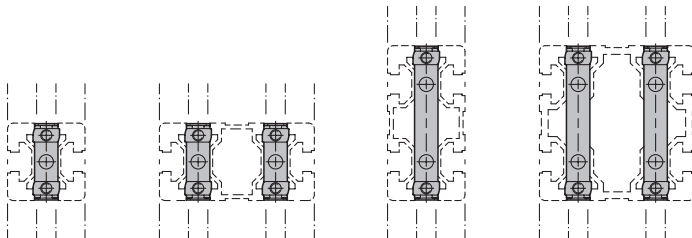

**Specification**

**Connector / Screws / T-slot nuts**  
Steel **SZ**  
Zinc plated, blue passivated finish

**Cover caps**  
Plastic, Polyamide (PA)  
Black ● **S**

**Guide pins**  
Plastic  
Black

RoHS

**Technical Information**  
Plastic Characteristics **QVX**

Bolt connectors GN 26b fasten aluminum profiles at right angles and secure them against twisting. Only one profile has to be machined. The connection can be freely positioned and slid along the slot. It is suitable for absorbing high loads, including torsional loads in particular. The cover caps ensure a visually appealing appearance. If panels are used, they must be suitably pocketed.

see also...	Page
<b>GN 10b</b> Aluminum Profiles (Profile Type Light)	QVX
<b>GN 10b</b> Aluminum Profiles (Profile Type Heavy)	QVX

**How to order**

<b>1</b>	<b>Length <math>l_1</math></b>
<b>2</b>	<b>Slot width <math>n</math></b>
<b>3</b>	<b>Type</b>
<b>4</b>	<b>Coding</b>
<b>5</b>	<b>Material / Finish</b>
<b>6</b>	<b>Color of the cover cap</b>

**GN 26b-90 10-N-C-SZS**

## Metric table

<b>1</b>	<b>2</b>	Dimensions in: millimeters / inches						
$I_1$ Nominal size	n	$d_1$	$d_2$	$d_3$	$l_2 \approx$	$m_1$	$m_2$	Tightening torque in Nm
30 1.18	8 0.31	M 5	7.3 0.29	11 0.43	29 1.14	18 0.71	18 0.71	6
40 1.57	10 0.39	M 8	10 0.39	17 0.67	37 1.46	23 0.91	22.5 0.89	25
45 1.77	10 0.39	M 8	10 0.39	17 0.67	42 1.65	28 1.10	22.5 0.89	25
60 2.36	10 0.39	M 8	10 0.39	17 0.67	57 2.24	43 1.69	22.5 0.89	25
80 3.15	10 0.39	M 8	10 0.39	17 0.67	77 3.03	63 2.48	22.5 0.89	25
90 3.54	10 0.39	M 8	10 0.39	17 0.67	87 3.43	73 2.87	22.5 0.89	25

## Assembly Instructions / Profile Machining

