

Metric table

Dimensions in: millimeters - inches

| ¹ d ₁ | ² d ₂ n6 | d ₃ | d ₄ Diameter of counterbore | Length l |
|-----------------------------|--------------------------------|----------------|--|------------|
| 6 0.24 | 10 0.39 | 12.5 0.49 | 13.5 0.53 | 8 0.31 |
| 8 0.31 | 12 0.47 | 15 0.59 | 16 0.63 | 10 0.39 |
| 10 0.39 | 15 0.59 | 19 0.75 | 20.6 0.81 | 12 0.47 |

Specification

- Steel, hardened to HRC 62 ±2
- ISO Fundamental Tolerances → page 2129
- RoHS compliant

Information

GN 172.1 and GN 179.1 press-fit guide bushings with conical bore are used with GN 771.2 tapered locating pins or, as a latch bore for GN 817.5 indexing plungers with conical pin.

| | |
|---|---------------------------|
| How to order (With flange) ¹ ² GN 172.1-8-12 | 1 Bore d ₁ |
| | 2 Diameter d ₂ |

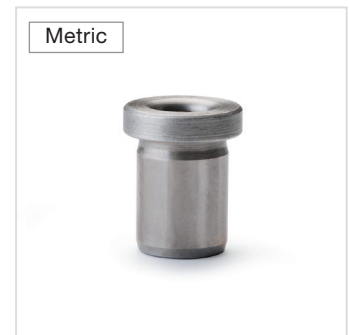
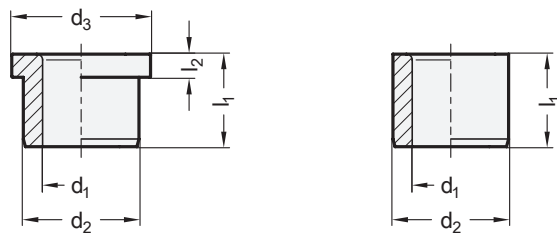

Metric table

³ Type

A Bore filleted on one side

Dimensions in: millimeters - inches

| ¹ d ₁ F7 | ² l ₁ | | d ₂ n6 | d ₃ | l ₂ |
|--------------------------------|-----------------------------|------------|-------------------|----------------|----------------|
| B 6 | 10 0.39 | 16 0.63 | 10 0.39 | 13 0.51 | 3 0.12 |
| B 8 | 10 0.39 | 16 0.63 | 12 0.47 | 15 0.59 | 3 0.12 |
| B 10 | 12 0.47 | 20 0.79 | 15 0.59 | 18 0.71 | 3 0.12 |

Specification

- Steel, hardened to HRC 62 ±2
- ISO Fundamental Tolerances → page 2129
- RoHS compliant

Information

The above dimensions are only a short list of parts available in series DIN 172 / DIN 179 → page 1172.

| | |
|--|-------------------------|
| How to order (Without flange) ¹ ² ³ DIN179-B8-16-A | 1 Bore d ₁ |
| | 2 Length l ₁ |
| | 2 Type |

3.1
3.2
3.3
3.4
3.5
3.6
3.7
3.8
3.9
3.10